

- 4.1 **Tekweywinen tel weljesultiek**  
Be with Us in Our Joy
- 4.2 **How Do I Look?**  
Ways of Understanding Art
- 4.3 **From This Place** Our Lives on  
Land and Sea
- 4.4 **Here, We Made a Home**
- 4.5 **Talamh An Éisc** The Fishing Ground

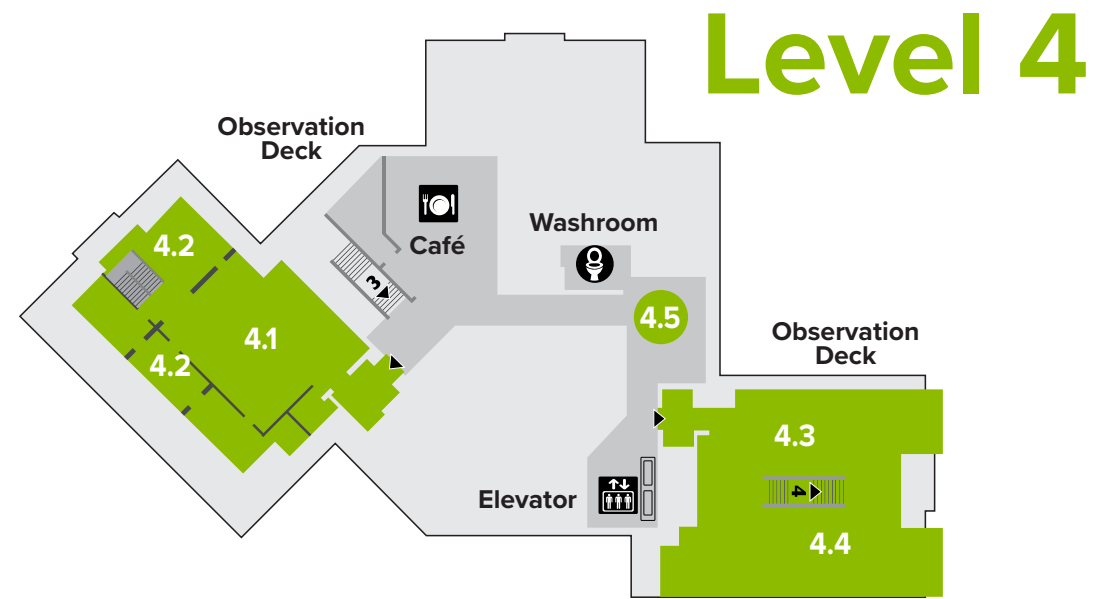

- 3.1 **Connections** This Place and Its Early People
- 3.2 **Disappearing Ice** Changing Seascapes
- 3.3 **Denyse Thomasos** just beyond
- 3.4 **Ginok Song** I Reach Home, I am Serene  
송진옥: 나는 집으로 다다르고, 고요함이 된다
- 3.5 **A Dog's Age**

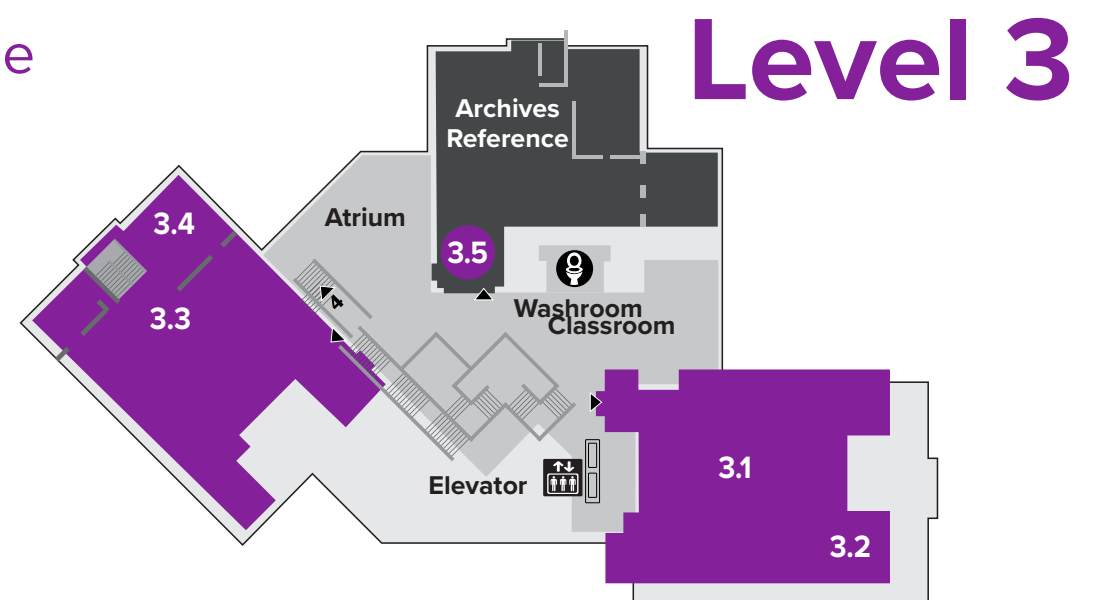

- 2.1 **Beaumont-Hamel and the Trail of the Caribou**
- 2.2 **Fantastic Finds** Archaeology in  
Newfoundland and Labrador
- 2.3 Closed for installation.  
(Amber Lynn Thorne opening January)
- 2.4 **The Rodney**

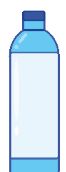
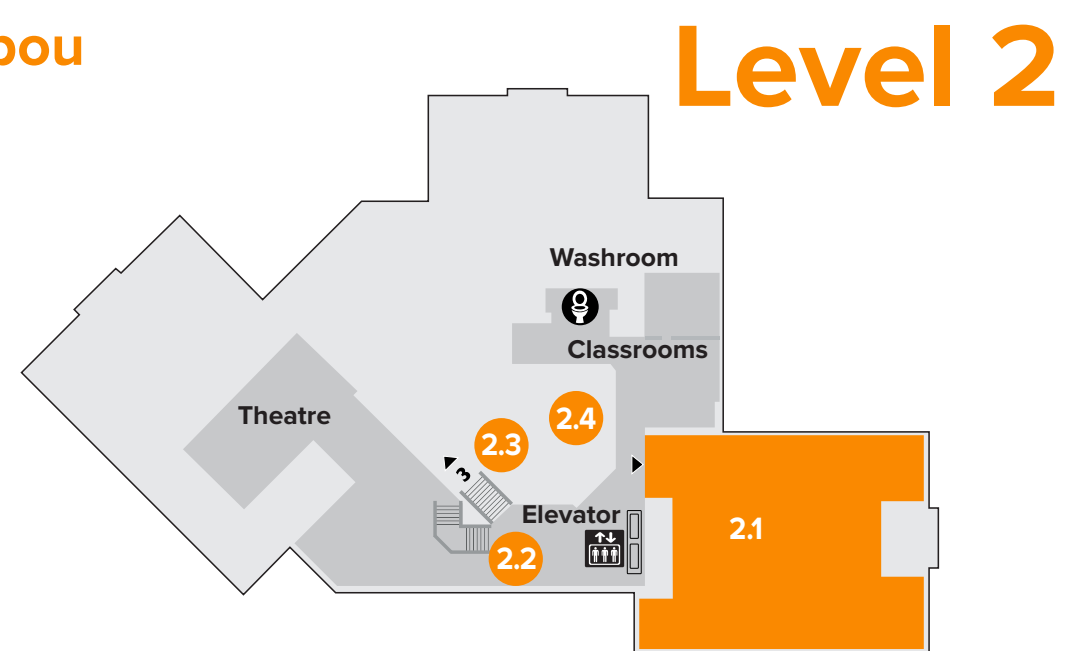

Water Bottle Filling Station on Level 2 at entrance to 2.1

# FLOOR PLAN

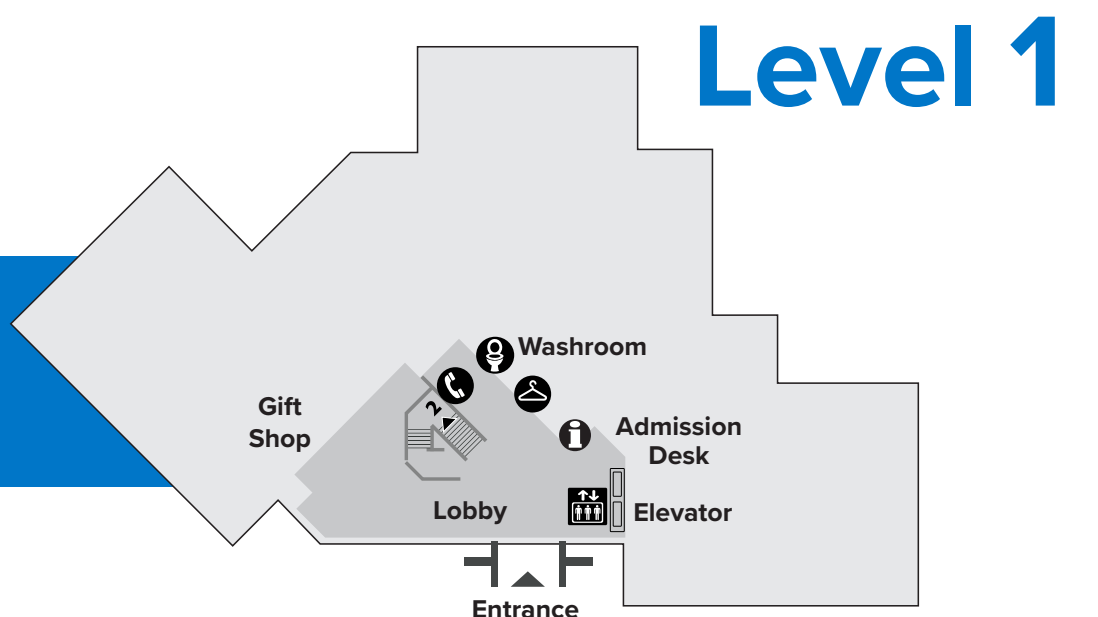

Change tables available in washrooms on levels 1, 2, 3, and 4

**Click me for more information on our exhibits!**

Share your visit on social media

#RoomsNL



@therooms\_nl



@therooms\_nl



@therooms\_nl